

TECHNICAL DATA:

Easily accessible device,
according to standard EN 1176-1:2017

Device dimensions: 8,27x3,80m
 Device height: 2,16m
 Minimum space: 11,32x6,79m
 Falling area: 69,00m²
 Critical fall height: 1,80m
 Foundations depth: -0,60

Projection and device view

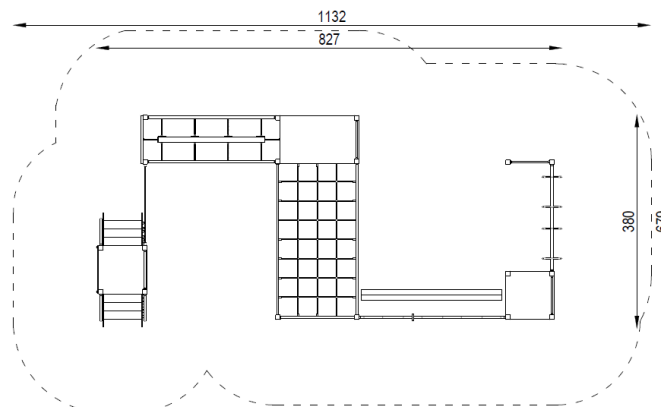

The device according to EN 1176-1:2017
 Playground equipment and surfacing – Part 1:
 General safety requirements and test methods

Safety surfaces:
 - turf/topsoil, sand, gravel, bark, synthetic surface
 - minimal thickness for loose particulate materials
 200+100mm
 - synthetic surface according to critical fall height

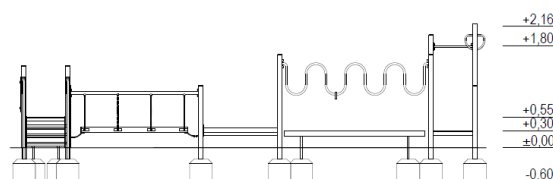

COMPONENTS:

Tower without roof, platform 30cm	2 pcs
Tower without roof, platform 55cm	1 pc
Entry stairs 55cm	2 pcs
Horizontal ropenet 160 cm x 80 cm	1 pc
Mobile bridge	1 pc
Balance beam	1 pc
Bending set	2 pcs

MATERIALS:

Construction poles:	steel square profiles, galvanized, powder coated in gray
Flat decorative elements:	HDPE sheets
Platforms, gangway:	waterproof plywood, with anti-slip layer, based on steel structure
Steel elements:	galvanized steel, powder coated
Ropes:	polypropylene braided with a steel, interconnected by plastic fasteners
Caps:	plastic
Foundations:	concrete min. C12/15 standard



SATERNUS DISTRIBUTION Sp. z o.o. sp.k.
ul. Nowa 32
41-500 Chorzów, Poland

Certificate holder:
Producer:
Distributor:

GRUPA SATERNUS Sp. z o.o. S. K. A. reserves all rights to protect copyright under the Act of February 4, 1994 on Copyright and Related Rights (Journal of Laws No. 28, pc 83), and in particular Art. 78 and 79 of this Law.

GRUPA SATERNUS Sp. z o.o. S. K. A.
Saternus Production Sp. z o.o. sp. k.
Saternus Distribution Sp. z o.o. sp. k.